

## Product Specification Sheet

Product name – Semi Dome Junior Stainless Steel Bollard Ø 76mm



Manufacturer / Brand	Pittman®
Warranty	1 year manufacturer's warranty
Material	304 grade stainless steel
Components	Single bollard with anchor bar
Dimensions	1200(H) x 76(Ø)mm
Features	304 grade stainless steel Suitable for non-coastal areas Cast into concrete Semi dome design for modern settings

**Ireland:**  
B2 Athy Business Campus  
Athy, Co. Kildare R14 PK74  
Ph: 01 531 2777  
Email: [sales@pittman.ie](mailto:sales@pittman.ie)

**United Kingdom:**  
1310 Solihull Parkway, Birmingham Business Park  
Birmingham B37 7YB  
Ph: 0121 630 3527  
[sales@pittman.uk](mailto:sales@pittman.uk)

ITEM NO.	PART NUMBER	QTY.
1	SEMI76-2	1
2	PEG	2
3	Tube 76 x 2 x 1200 Long	1

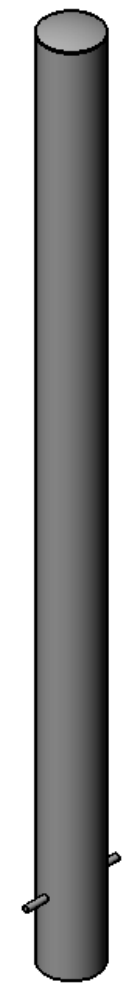
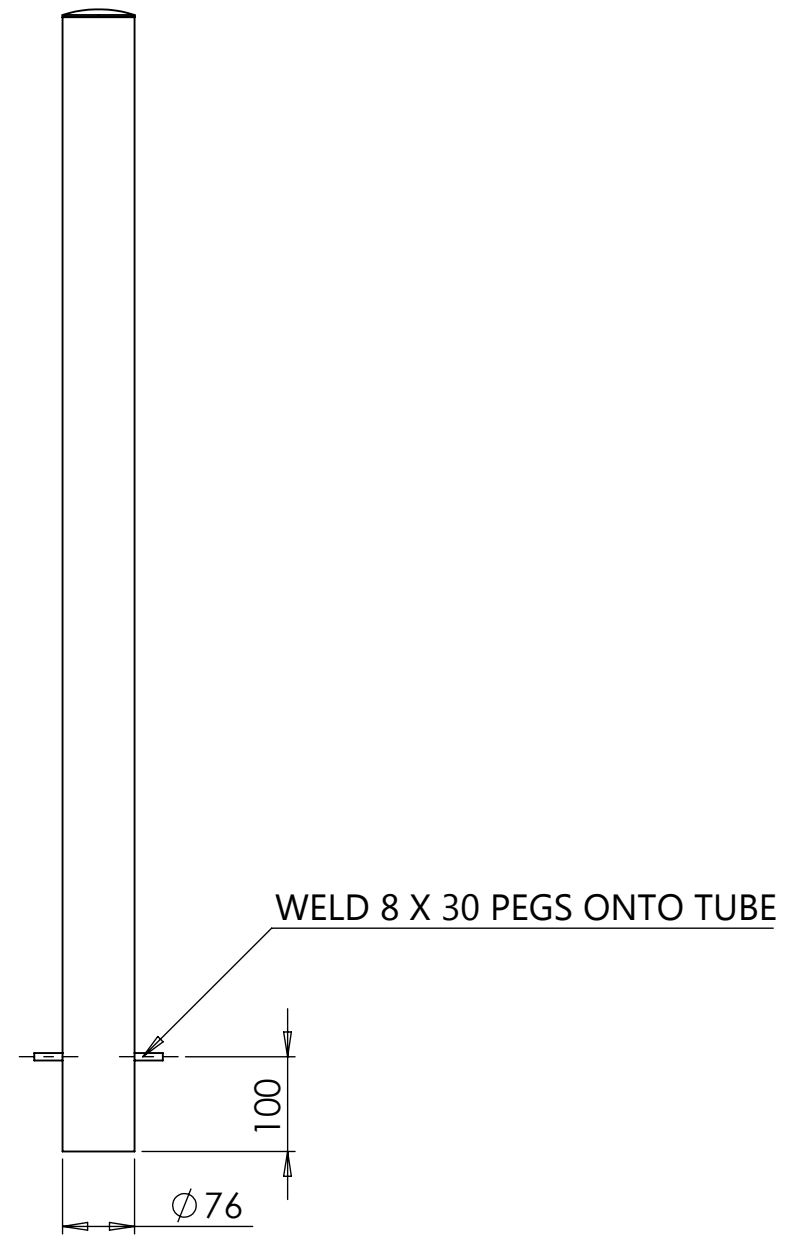
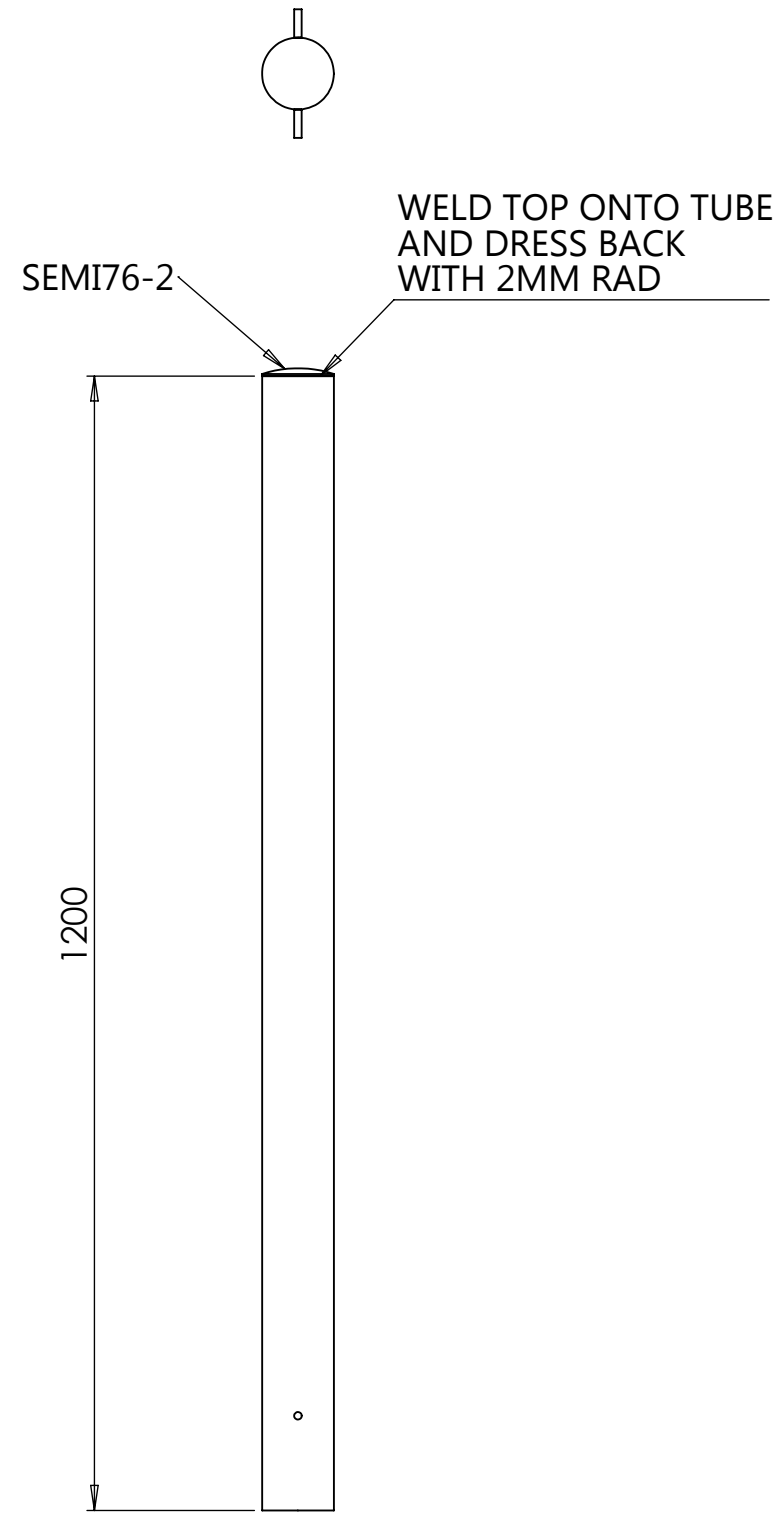

DEBURR AND BREAK SHARP EDGES DO NOT SCALE DRAWING	DRAWN: CAB	DATE: 01/09/15	REVISION: A
	<b>pittman</b> <sup>®</sup>		
UNLESS OTHERWISE SPECIFIED: DIMENSIONS ARE IN MILLIMETERS TOLERANCES: LINEAR: +1MM ANGULAR: +1DEG	TITLE: BOLLARD 76 $\phi$ X 1200MM SEMI DOME ROOT FIXED		
	DWG NO. <b>BOL-76-D1200-F-0</b>		
	FINISH: SEE JOB SHEET	SCALE: 1:8	A3
MATERIAL: SEE B.O.M			SHEET 1 OF 1