

Beacon Dalia

IBDAL100

pittman[®]



The Dalia beacon is a highly efficient product designed for lighting and marking paths, parks and pedestrian areas.

Among its main features, its mechanical robustness and resistance to corrosion should be highlighted.

Made of hot-dip galvanised steel with epoxy primer coating and baked black oxiron polyester coating.

Top cover made of bright polished stainless steel. The diffuser made of glazed methacrylate, making the light very uniform. LED module built into the beacon itself to form an integrated unit.

Easy maintenance thanks to the installation of an inspection door according to EN40 and low-voltage electrical regulations, making it easy to change the bulb by removing the stainless steel cover on the top.

Recommended anchoring: by means of four M16 bolts.

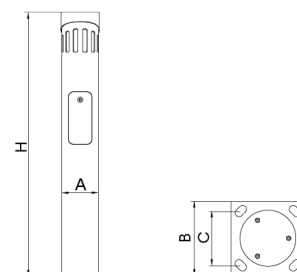

Ref.	ØA	B	C	H
IBDAL100	140	190	140	1000

